

2nd Floor

Sources: Point2 Surveyors:
Site Photos
Point Cloud Data

Ordnance Survey:
OS Map
Zmap

SimpsonHaugh and Partners:
Received 03/12/18
10061-Z0-G200-3-AL-Detailed Model.dwg
10106-A-DRG-Z0-G100-4000(0-3).dwg's Elevations
10106-A-DRG-Z0-G200-2000(00-31).dwg's Plans

Key:

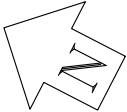

Project: Kensington Forum Hotel

Title: ADF Results and Room Layouts
Proposed Scheme 03/12/18

Drawn By: SA/CJ

Scale: 1:125@A3

Date: DEC 2018

Dwg No: P813/INT/42

Point 2 Surveyors Ltd,
3rd Floor
17 Slingsby Place,
London WC2E 9AB,
0207 836 5828
www.point2surveyors.com



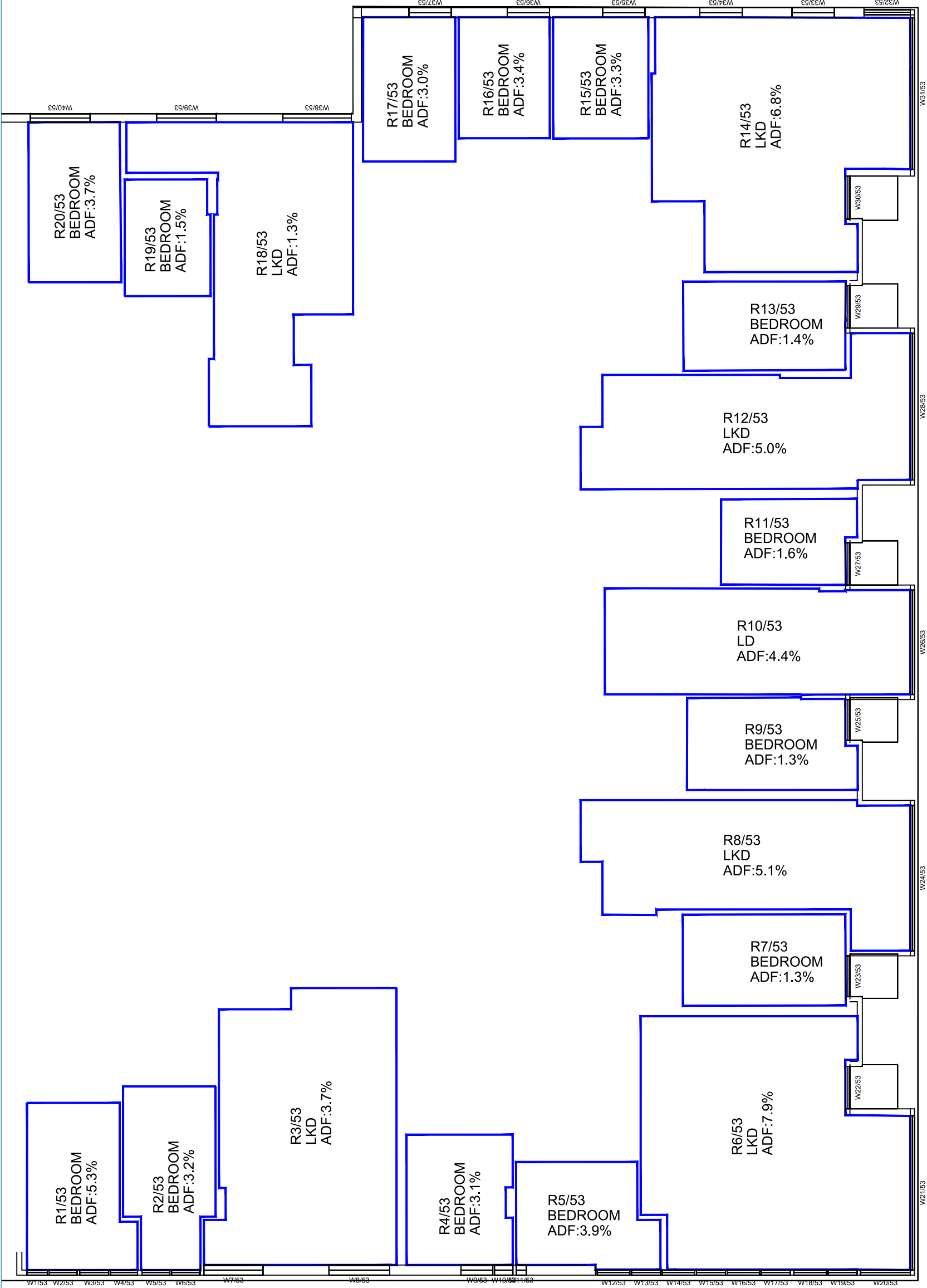

3rd Floor

Sources: Point2 Surveyors:
Site Photos
Point Cloud Data

Ordnance Survey:
OS Map
Zmap

SimpsonHaugh and Partners:
Received 03/12/18
10061-Z0-G200-3-AL-Detailed Model.dwg
10106-A-DRG-Z0-G100-4000(0-3).dwg's Elevations
10106-A-DRG-Z0-G200-2000(00-31).dwg's Plans

Key:



Project: Kensington Forum Hotel

Title: ADF Results and Room Layouts
Proposed Scheme 03/12/18

Drawn By: SA/CJ

Scale: 1:125@A3

Date: DEC 2018

Dwg No: P813/INT/43

Point 2 Surveyors Ltd,
3rd Floor
17 Slingsby Place,
London WC2E 9AB,
0207 836 5828
www.point2surveyors.com



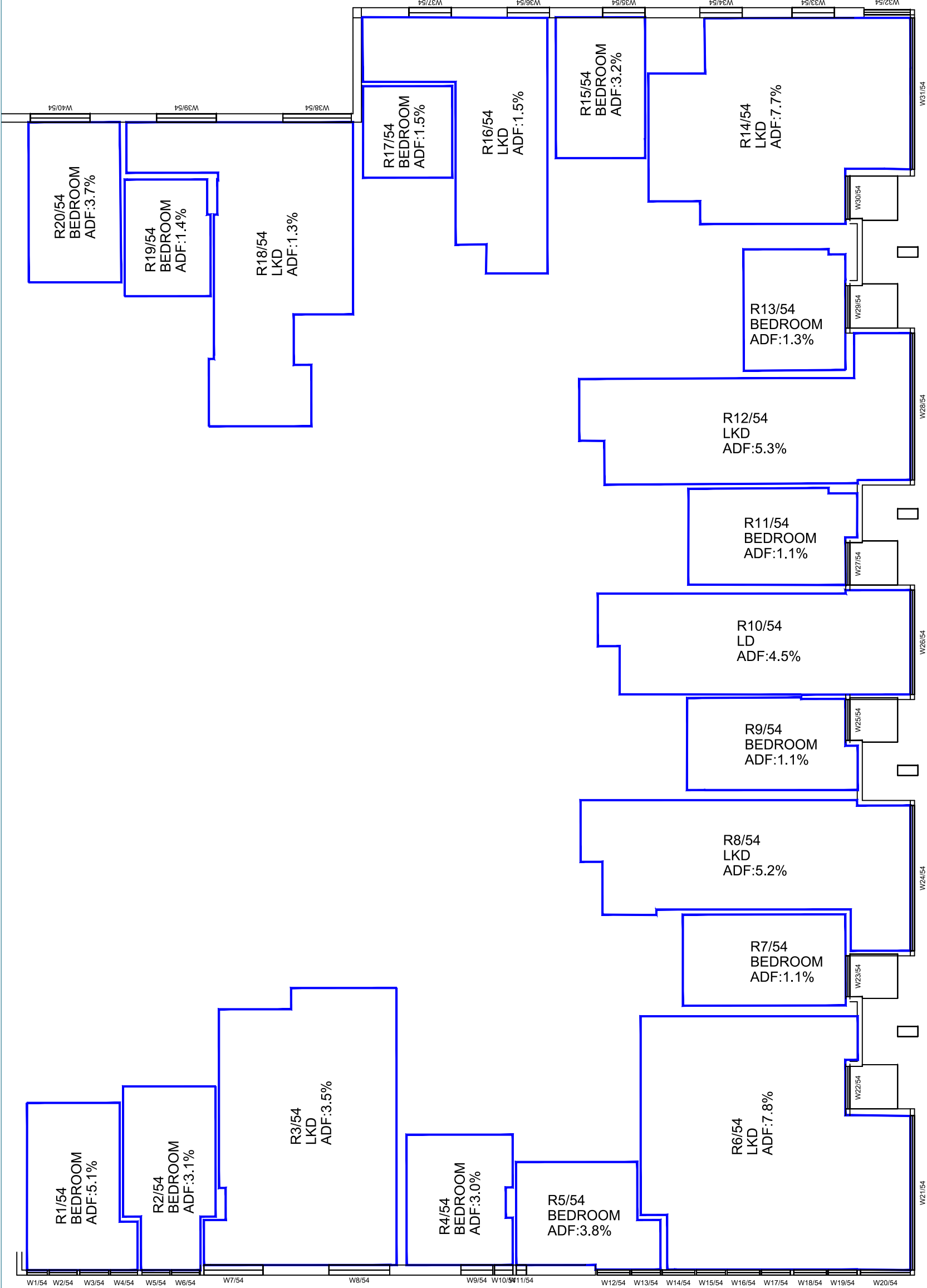

4th Floor

Sources: Point2 Surveyors:
Site Photos
Point Cloud Data

Ordnance Survey:
OS Map
Zmap

SimpsonHaugh and Partners:
Received 03/12/18
10061-Z0-G200-3-AL-Detailed Model.dwg
10106-A-DRG-Z0-G100-4000(0-3).dwg's Elevations
10106-A-DRG-Z0-G200-2000(00-31).dwg's Plans

Key:

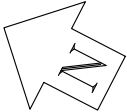

Project: Kensington Forum Hotel

Title: ADF Results and Room Layouts
Proposed Scheme 03/12/18

Drawn By: SA/CJ

Scale: 1:125@A3

Date: DEC 2018

Dwg No: P813/INT/44

Point 2 Surveyors Ltd,
3rd Floor
17 Slingsby Place,
London WC2E 9AB,
0207 836 5828
www.point2surveyors.com



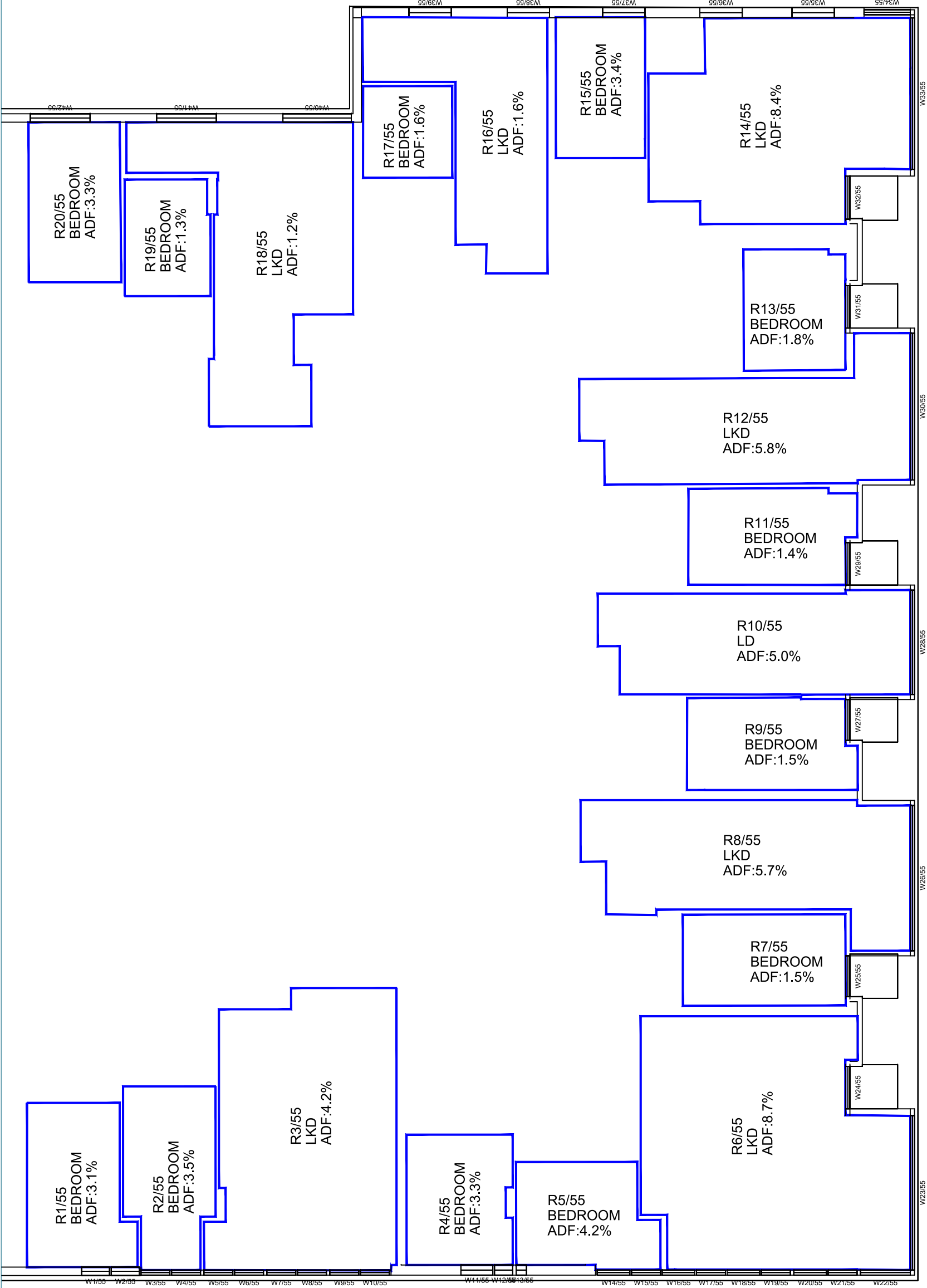

5th Floor

Sources: Point2 Surveyors:
Site Photos
Point Cloud Data

Ordnance Survey:
OS Map
Zmap

SimpsonHaugh and Partners:
Received 03/12/18
10061-Z0-G200-3-AL-Detailed Model.dwg
10106-A-DRG-Z0-G100-4000(0-3).dwg's Elevations
10106-A-DRG-Z0-G200-2000(00-31).dwg's Plans

Key:

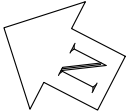

Project: Kensington Forum Hotel

Title: ADF Results and Room Layouts
Proposed Scheme 03/12/18

Drawn By: SA/CJ

Scale: 1:125@A3

Date: DEC 2018

Dwg No: P813/INT/45

Point 2 Surveyors Ltd,
3rd Floor
17 Slingsby Place,
London WC2E 9AB,
0207 836 5828
www.point2surveyors.com



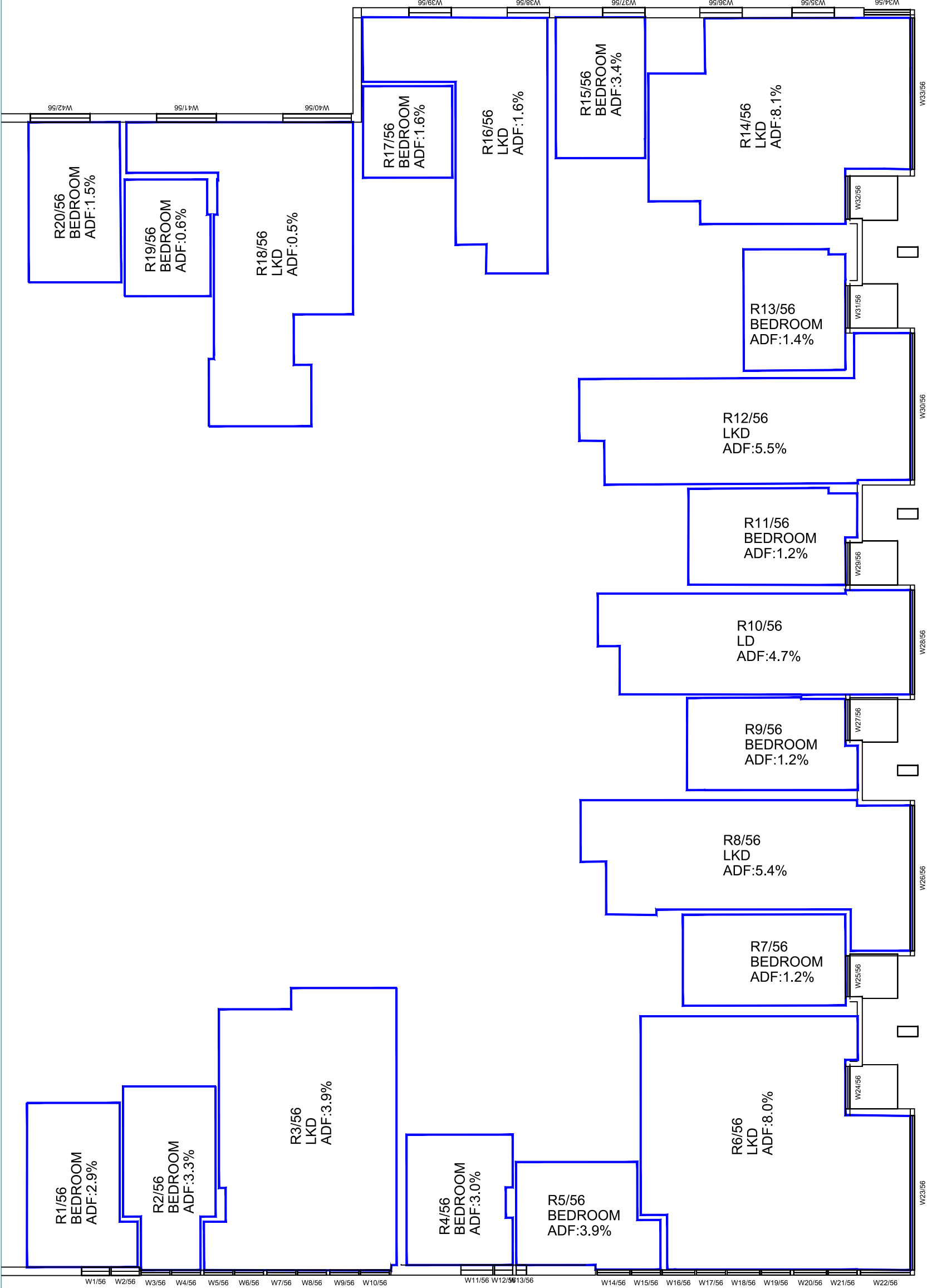

6th Floor

Sources: Point2 Surveyors:
Site Photos
Point Cloud Data

Ordnance Survey:
OS Map
Zmap

SimpsonHaugh and Partners:
Received 03/12/18
10061-Z0-G200-3-AL-Detailed Model.dwg
10106-A-DRG-Z0-G100-4000(0-3).dwg's Elevations
10106-A-DRG-Z0-G200-2000(00-31).dwg's Plans

Key:



Project: Kensington Forum Hotel

Title: ADF Results and Room Layouts
Proposed Scheme 03/12/18

Drawn By: SA/CJ

Scale: 1:125@A3

Date: DEC 2018

Dwg No: P813/INT/46

Point 2 Surveyors Ltd,
3rd Floor
17 Slingsby Place,
London WC2E 9AB,
0207 836 5828
www.point2surveyors.com



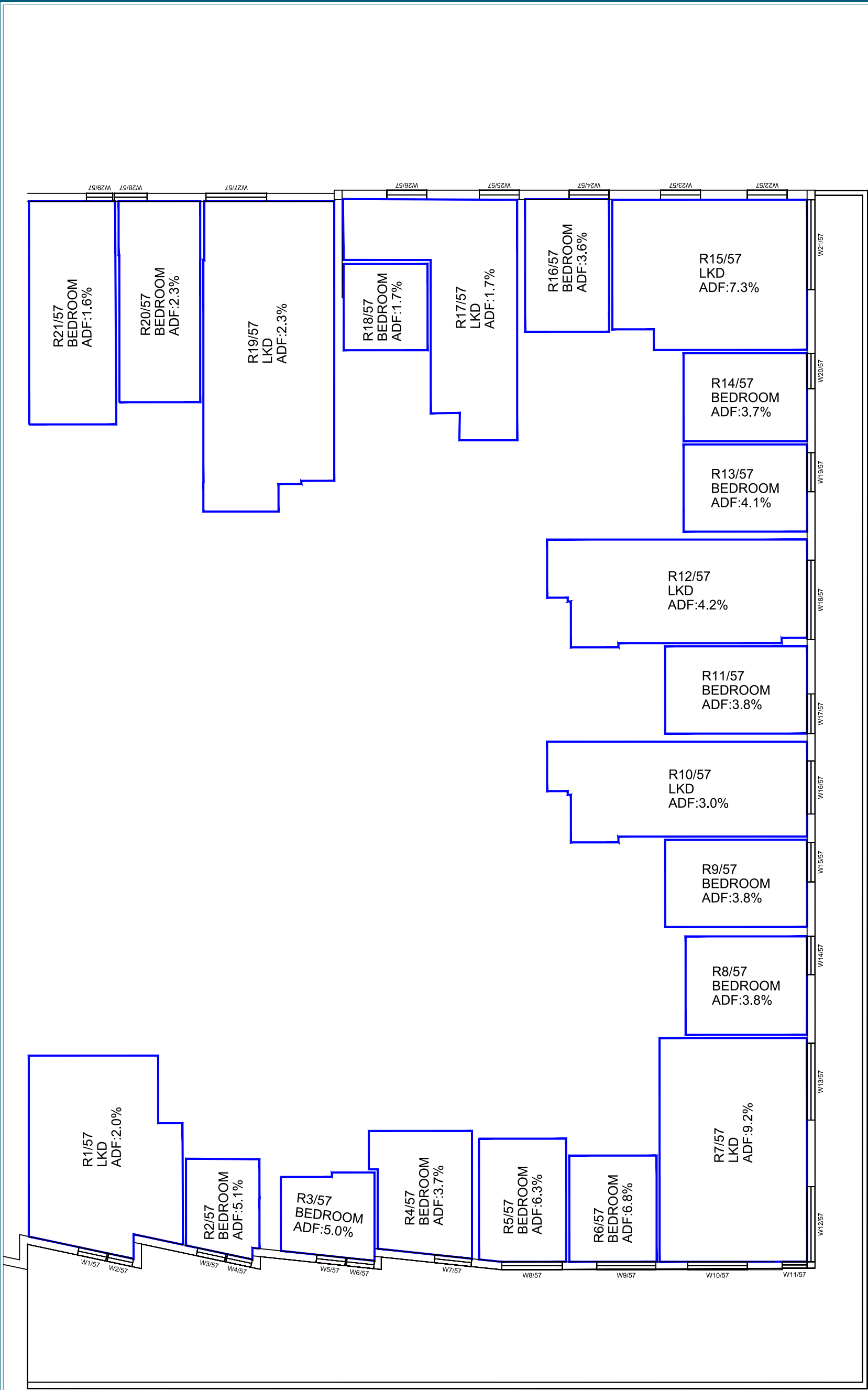

7th Floor

Sources: Point2 Surveyors:
Site Photos
Point Cloud Data

Ordnance Survey:
OS Map
Zmap

SimpsonHaugh and Partners:
Received 03/12/18
10061-Z0-G200-3-AL-Detailed Model.dwg
10106-A-DRG-Z0-G100-4000(0-3).dwg's Elevations
10106-A-DRG-Z0-G200-2000(00-31).dwg's Plans

Key:

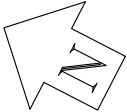

Project: Kensington Forum Hotel

Title: ADF Results and Room Layouts
Proposed Scheme 03/12/18

Drawn By: SA/CJ

Scale: 1:125@A3

Date: DEC 2018

Dwg No: P813/INT/47

Point 2 Surveyors Ltd,
3rd Floor
17 Slingsby Place,
London WC2E 9AB,
0207 836 5828
www.point2surveyors.com



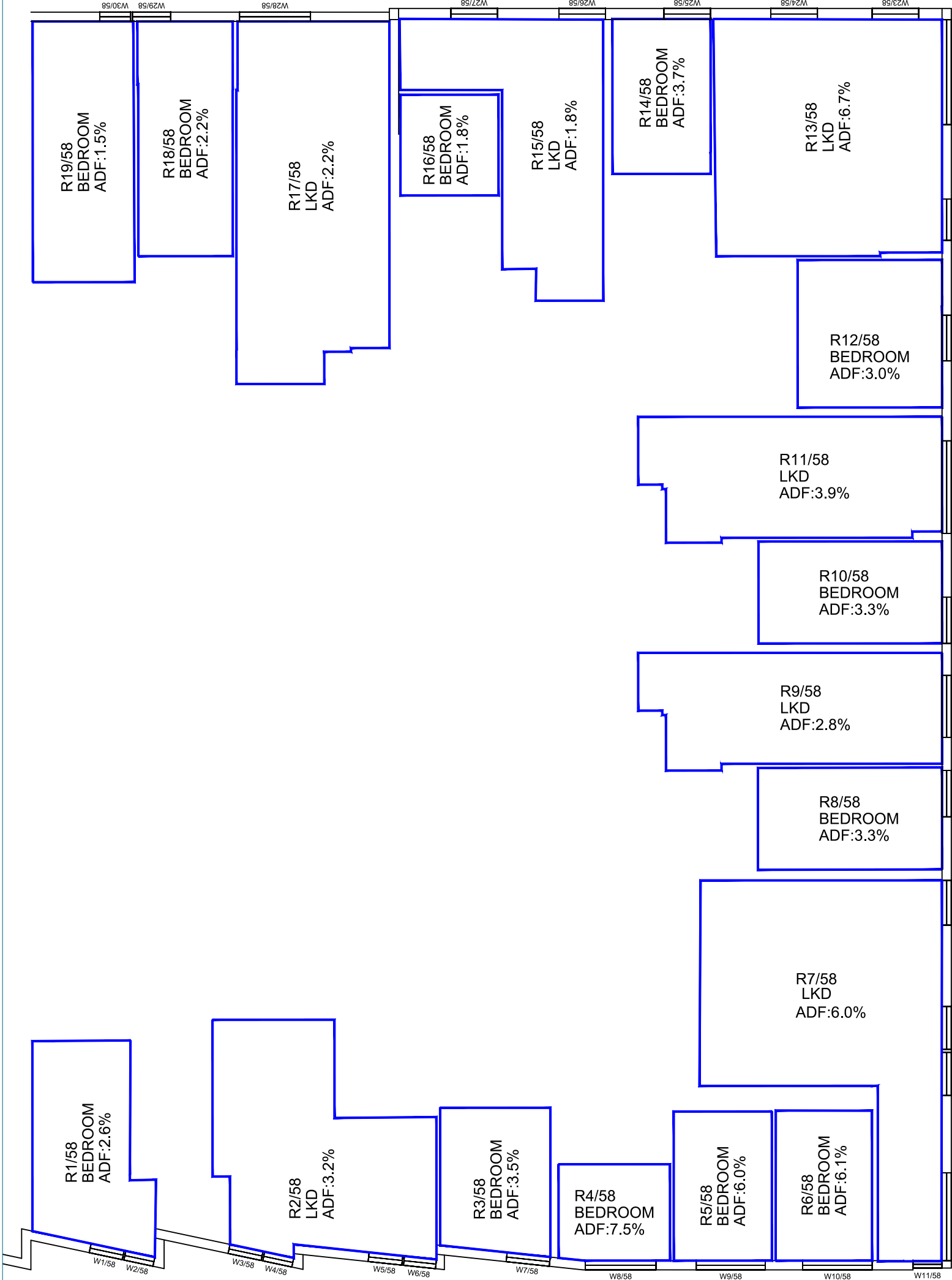

8th Floor

Sources: Point2 Surveyors:
Site Photos
Point Cloud Data

Ordnance Survey:
OS Map
Zmap

SimpsonHaugh and Partners:
Received 03/12/18
10061-Z0-G200-3-AL-Detailed Model.dwg
10106-A-DRG-Z0-G100-4000(0-3).dwg's Elevations
10106-A-DRG-Z0-G200-2000(00-31).dwg's Plans

Key:

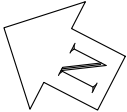

Project: Kensington Forum Hotel

Title: ADF Results and Room Layouts
Proposed Scheme 03/12/18

Drawn By: SA/CJ

Scale: 1:125@A3

Date: DEC 2018

Dwg No: P813/INT/48

Point 2 Surveyors Ltd,
3rd Floor
17 Slingsby Place,
London WC2E 9AB,
0207 836 5828
www.point2surveyors.com







Room	Roomuse	Flat	Window	VSc(%)	ADF(%)	TOTAL ADF(%)
Proposed Scheme						
R1/50	BEDROOM		W1/50	6.23	0.72	0.72
R2/50	BEDROOM		W2/50	6.39	1.06	
R2/50	BEDROOM		W3/50	6.58	0.20	1.26
R3/50	LKD		W4/50	6.73	0.37	
R3/50	LKD		W5/50	6.86	0.55	0.93
R4/50	BEDROOM		W6/50	6.98	0.91	0.91
R5/50	BEDROOM		W7/50	6.97	1.78	1.78
R6/50	BEDROOM		W8/50	7.03	0.89	
R6/50	BEDROOM		W9/50	5.94	0.66	1.56
R7/50	BEDROOM		W10/50	5.92	0.27	0.27
R8/50	LKD		W11/50	2.27	0.11	
R8/50	LKD		W12/50	5.83	0.56	0.68
R9/50	BEDROOM		W13/50	2.32	0.29	0.29
R10/50	BEDROOM		W14/50	5.87	1.25	1.25
R11/50	BEDROOM		W15/50	2.40	0.44	0.44
R12/50	LKD		W16/50	5.93	0.57	
R12/50	LKD		W17/50	2.54	0.16	0.73
R13/50	LKD		W18/50	3.16	0.23	
R13/50	LKD		W19/50	7.00	0.78	
R13/50	LKD		W20/50	24.23	0.68	
R13/50	LKD		W21/50	24.17	0.62	2.31
R14/50	BEDROOM		W22/50	23.94	2.23	2.23
R15/50	BEDROOM		W23/50	23.72	2.25	2.25
R16/50	BEDROOM		W24/50	23.48	2.00	2.00
R1/51	BEDROOM		W1/51	31.36	0.57	
R1/51	BEDROOM		W2/51	32.09	2.16	
R1/51	BEDROOM		W3/51	32.26	1.07	
R1/51	BEDROOM		W4/51	32.29	0.75	4.56
R2/51	LKD		W5/51	32.28	0.49	
R2/51	LKD		W6/51	32.33	0.64	
R2/51	LKD		W7/51	32.34	1.28	
R2/51	LKD		W8/51	32.36	0.62	
R2/51	LKD		W9/51	32.38	1.24	4.26
R3/51	BEDROOM		W10/51	32.40	2.92	
R3/51	BEDROOM		W11/51	32.42	0.72	3.64
R4/51	BEDROOM		W12/51	32.40	0.29	
R4/51	BEDROOM		W13/51	32.37	1.52	
R4/51	BEDROOM		W14/51	32.35	2.66	4.47

Room	Roomuse	Flat	Window	VSc(%)	ADF(%)	TOTAL ADF(%)
R5/51	LKD		W15/51	32.34	0.43	
R5/51	LKD		W16/51	32.36	0.76	
R5/51	LKD		W17/51	32.36	0.43	
R5/51	LKD		W18/51	32.35	0.76	
R5/51	LKD		W19/51	32.32	0.43	
R5/51	LKD		W20/51	32.27	0.76	
R5/51	LKD		W21/51	32.25	1.34	
R5/51	LKD		W22/51	27.73	3.76	9.17
R5/51	LKD		W23/51	10.53	0.50	
R6/51	BEDROOM		W24/51	10.51	1.75	1.75
R7/51	LKD		W25/51	27.67	5.65	5.65
R8/51	BEDROOM		W26/51	9.42	1.71	1.71
R9/51	LD		W27/51	27.64	4.88	4.88
R10/51	BEDROOM		W28/51	9.30	2.08	2.08
R11/51	LKD		W29/51	27.58	5.62	5.62
R12/51	BEDROOM		W30/51	10.86	1.90	1.90
R13/51	LKD		W31/51	11.22	0.58	
R13/51	LKD		W32/51	28.29	4.19	
R13/51	LKD		W33/51	26.66	1.19	
R13/51	LKD		W34/51	26.74	1.04	
R13/51	LKD		W35/51	26.54	1.03	8.02
R14/51	BEDROOM		W36/51	26.40	4.02	4.02
R15/51	BEDROOM		W37/51	26.17	4.09	4.09
R16/51	BEDROOM		W38/51	25.91	3.59	3.59
R1/52	BEDROOM		W1/52	33.09	3.44	3.44
R2/52	BEDROOM		W2/52	33.22	0.86	
R2/52	BEDROOM		W3/52	33.21	1.73	
R2/52	BEDROOM		W4/52	33.25	0.86	3.45
R3/52	LKD		W5/52	33.24	0.80	
R3/52	LKD		W6/52	33.29	0.41	
R3/52	LKD		W7/52	33.33	0.82	
R3/52	LKD		W8/52	33.55	0.40	
R3/52	LKD		W9/52	33.87	0.81	3.25
R4/52	BEDROOM		W10/52	34.12	2.20	
R4/52	BEDROOM		W11/52	34.14	0.55	2.76
R5/52	BEDROOM		W12/52	34.13	0.22	
R5/52	BEDROOM		W13/52	34.11	1.19	
R5/52	BEDROOM		W14/52	34.09	2.09	3.51
R6/52	LKD		W15/52	34.09	0.33	
R6/52	LKD		W16/52	34.09	0.58	
R6/52	LKD		W17/52	34.10	0.33	
R6/52	LKD		W18/52	34.09	0.58	
R6/52	LKD		W19/52	34.07	0.33	

Room	Roomuse	Flat	Window	VSc(%)	ADF(%)	TOTAL ADF(%)
R6/52	LKD		W20/52	34.04	0.58	
R6/52	LKD		W21/52	34.06	1.01	
R6/52	LKD		W22/52	31.11	3.00	
R6/52	LKD		W23/52	5.54	0.22	6.94
R7/52	BEDROOM		W24/52	5.54	0.79	0.79
R8/52	LKD		W25/52	31.04	4.51	4.51
R9/52	BEDROOM		W26/52	5.19	0.77	0.77
R10/52	LD		W27/52	30.97	3.86	3.86
R11/52	BEDROOM		W28/52	5.23	0.97	0.97
R12/52	LKD		W29/52	30.81	4.46	4.46
R13/52	BEDROOM		W30/52	5.60	0.86	0.86
R14/52	LKD		W31/52	5.95	0.26	
R14/52	LKD		W32/52	31.08	3.27	
R14/52	LKD		W33/52	28.59	0.92	
R14/52	LKD		W34/52	28.68	0.79	
R14/52	LKD		W35/52	28.46	0.79	6.03
R15/52	BEDROOM		W36/52	28.29	3.15	3.15
R16/52	BEDROOM		W37/52	28.05	3.22	3.22
R17/52	BEDROOM		W38/52	27.78	2.79	2.79
R18/52	LKD		W39/52	15.52	1.20	1.20
R19/52	BEDROOM		W40/52	24.16	1.37	1.37
R20/52	BEDROOM		W41/52	25.12	3.49	3.49
R1/53	BEDROOM		W1/53	36.03	0.66	
R1/53	BEDROOM		W2/53	36.01	1.88	
R1/53	BEDROOM		W3/53	36.05	0.97	
R1/53	BEDROOM		W4/53	36.04	1.82	5.34
R2/53	BEDROOM		W5/53	36.06	1.07	
R2/53	BEDROOM		W6/53	36.05	2.11	3.18
R3/53	LKD		W7/53	36.08	1.84	
R3/53	LKD		W8/53	36.15	1.89	3.73
R4/53	BEDROOM		W9/53	36.19	2.48	
R4/53	BEDROOM		W10/53	36.20	0.61	3.09
R5/53	BEDROOM		W11/53	36.19	0.24	
R5/53	BEDROOM		W12/53	36.19	1.33	
R5/53	BEDROOM		W13/53	36.16	2.33	3.89
R6/53	LKD		W14/53	36.17	0.37	
R6/53	LKD		W15/53	36.17	0.64	
R6/53	LKD		W16/53	36.18	0.37	
R6/53	LKD		W17/53	36.16	0.64	
R6/53	LKD		W18/53	36.16	0.37	

Room	Roomuse	Flat	Window	VSc(%)	ADF(%)	TOTAL ADF(%)
R6/53	LKD		W19/53	36.14	0.64	
R6/53	LKD		W20/53	36.12	1.14	
R6/53	LKD		W21/53	34.03	3.40	
R6/53	LKD		W22/53	11.16	0.37	7.92
R7/53	BEDROOM		W23/53	11.13	1.31	1.31
R8/53	LKD		W24/53	33.90	5.10	5.10
R9/53	BEDROOM		W25/53	9.89	1.28	1.28
R10/53	LD		W26/53	33.83	4.37	4.37
R11/53	BEDROOM		W27/53	9.87	1.60	1.60
R12/53	LKD		W28/53	33.62	5.05	5.05
R13/53	BEDROOM		W29/53	11.24	1.41	1.41
R14/53	LKD		W30/53	11.64	0.43	
R14/53	LKD		W31/53	33.66	3.69	
R14/53	LKD		W32/53	30.28	0.98	
R14/53	LKD		W33/53	30.30	0.83	
R14/53	LKD		W34/53	30.08	0.83	6.75
R15/53	BEDROOM		W35/53	29.90	3.33	3.33
R16/53	BEDROOM		W36/53	29.66	3.40	3.40
R17/53	BEDROOM		W37/53	29.39	2.96	2.96
R18/53	LKD		W38/53	16.58	1.30	1.30
R19/53	BEDROOM		W39/53	24.95	1.47	1.47
R20/53	BEDROOM		W40/53	25.93	3.75	3.75
R1/54	BEDROOM		W1/54	36.37	0.64	
R1/54	BEDROOM		W2/54	36.36	1.81	
R1/54	BEDROOM		W3/54	36.38	0.94	
R1/54	BEDROOM		W4/54	36.38	1.76	5.14
R2/54	BEDROOM		W5/54	36.39	1.03	
R2/54	BEDROOM		W6/54	36.38	2.04	3.06
R3/54	LKD		W7/54	36.41	1.71	
R3/54	LKD		W8/54	36.87	1.78	3.49
R4/54	BEDROOM		W9/54	37.30	2.40	
R4/54	BEDROOM		W10/54	37.31	0.60	3.00
R5/54	BEDROOM		W11/54	37.30	0.24	
R5/54	BEDROOM		W12/54	37.30	1.31	
R5/54	BEDROOM		W13/54	37.28	2.29	3.84
R6/54	LKD		W14/54	37.29	0.36	
R6/54	LKD		W15/54	37.28	0.63	
R6/54	LKD		W16/54	37.28	0.36	
R6/54	LKD		W17/54	37.27	0.63	
R6/54	LKD		W18/54	37.27	0.36	

Kensington Forum		INTERNAL DAYLIGHT ANALYSIS PROPOSED SCHEME 03/12/18				DEC 2018
Room	Roomuse	Flat	Window	VSc(%)	ADF(%)	TOTAL ADF(%)
R6/54	LKD		W19/54	37.26	0.63	
R6/54	LKD		W20/54	37.28	1.11	
R6/54	LKD		W21/54	36.22	3.46	
R6/54	LKD		W22/54	8.13	0.31	7.84
R7/54	BEDROOM		W23/54	8.10	1.10	1.10
R8/54	LKD		W24/54	36.10	5.20	5.20
R9/54	BEDROOM		W25/54	7.56	1.06	1.06
R10/54	LD		W26/54	36.03	4.55	4.55
R11/54	BEDROOM		W27/54	7.61	1.07	1.07
R12/54	LKD		W28/54	35.80	5.32	5.32
R13/54	BEDROOM		W29/54	8.02	1.32	1.32
R14/54	LKD		W30/54	8.43	0.40	
R14/54	LKD		W31/54	35.59	4.24	
R14/54	LKD		W32/54	31.79	1.14	
R14/54	LKD		W33/54	31.84	0.97	
R14/54	LKD		W34/54	31.62	0.96	7.71
R15/54	BEDROOM		W35/54	31.43	3.19	3.19
R16/54	LKD		W36/54	31.19	1.52	1.52
R17/54	BEDROOM		W37/54	30.93	1.50	1.50
R18/54	LKD		W38/54	16.52	1.28	1.28
R19/54	BEDROOM		W39/54	24.86	1.44	1.44
R20/54	BEDROOM		W40/54	25.76	3.68	3.68
R1/55	BEDROOM		W1/55	38.87	1.02	
R1/55	BEDROOM		W2/55	38.87	2.07	3.08
R2/55	BEDROOM		W3/55	38.86	1.18	
R2/55	BEDROOM		W4/55	38.85	2.36	3.54
R3/55	LKD		W5/55	38.87	0.47	
R3/55	LKD		W6/55	38.86	0.93	
R3/55	LKD		W7/55	38.86	0.47	
R3/55	LKD		W8/55	38.86	0.93	
R3/55	LKD		W9/55	38.88	0.47	
R3/55	LKD		W10/55	38.88	0.93	4.20
R4/55	BEDROOM		W11/55	38.88	2.63	
R4/55	BEDROOM		W12/55	38.88	0.63	3.26
R5/55	BEDROOM		W13/55	38.87	0.26	
R5/55	BEDROOM		W14/55	38.87	1.42	
R5/55	BEDROOM		W15/55	38.86	2.49	4.17
R6/55	LKD		W16/55	38.87	0.39	
R6/55	LKD		W17/55	38.87	0.69	
R6/55	LKD		W18/55	38.87	0.39	

Kensington Forum		INTERNAL DAYLIGHT ANALYSIS PROPOSED SCHEME 03/12/18				DEC 2018
Room	Roomuse	Flat	Window	VSc(%)	ADF(%)	TOTAL ADF(%)
R6/55	LKD		W19/55	38.86	0.69	
R6/55	LKD		W20/55	38.87	0.39	
R6/55	LKD		W21/55	38.88	0.69	
R6/55	LKD		W22/55	38.88	1.22	
R6/55	LKD		W23/55	38.25	3.79	8.67
R6/55	LKD		W24/55	13.38	0.43	
R7/55	BEDROOM		W25/55	13.36	1.49	1.49
R8/55	LKD		W26/55	38.10	5.70	5.70
R9/55	BEDROOM		W27/55	11.96	1.46	1.46
R10/55	LD		W28/55	38.00	4.97	4.97
R11/55	BEDROOM		W29/55	11.83	1.44	1.44
R12/55	LKD		W30/55	37.84	5.82	5.82
R13/55	BEDROOM		W31/55	13.23	1.80	1.80
R14/55	LKD		W32/55	13.68	0.55	
R14/55	LKD		W33/55	37.43	4.82	
R14/55	LKD		W34/55	33.35	1.21	
R14/55	LKD		W35/55	33.34	1.02	
R14/55	LKD		W36/55	33.13	1.01	8.41
R15/55	BEDROOM		W37/55	32.94	3.35	3.35
R16/55	LKD		W38/55	32.72	1.60	1.60
R17/55	BEDROOM		W39/55	32.48	1.59	1.59
R18/55	LKD		W40/55	14.54	1.16	1.16
R19/55	BEDROOM		W41/55	21.76	1.30	1.30
R20/55	BEDROOM		W42/55	22.28	3.26	3.26
R1/56	BEDROOM		W1/56	38.12	0.95	
R1/56	BEDROOM		W2/56	38.12	1.92	2.87
R2/56	BEDROOM		W3/56	38.03	1.09	
R2/56	BEDROOM		W4/56	38.03	2.19	3.28
R3/56	LKD		W5/56	38.04	0.43	
R3/56	LKD		W6/56	38.04	0.86	
R3/56	LKD		W7/56	38.04	0.43	
R3/56	LKD		W8/56	38.04	0.86	
R3/56	LKD		W9/56	38.06	0.43	
R3/56	LKD		W10/56	38.06	0.86	3.86
R4/56	BEDROOM		W11/56	38.05	2.44	
R4/56	BEDROOM		W12/56	38.05	0.59	3.03
R5/56	BEDROOM		W13/56	38.05	0.25	
R5/56	BEDROOM		W14/56	38.07	1.31	
R5/56	BEDROOM		W15/56	38.06	2.30	3.86
R6/56	LKD		W16/56	38.07	0.36	

Kensington Forum		INTERNAL DAYLIGHT ANALYSIS PROPOSED SCHEME 03/12/18				DEC 2018
Room	Roomuse	Flat	Window	VSC(%)	ADF(%)	TOTAL ADF(%)
R6/56	LKD		W17/56	38.08	0.63	
R6/56	LKD		W18/56	38.08	0.36	
R6/56	LKD		W19/56	38.08	0.63	
R6/56	LKD		W20/56	38.10	0.36	
R6/56	LKD		W21/56	38.13	0.63	
R6/56	LKD		W22/56	38.29	1.12	
R6/56	LKD		W23/56	38.74	3.59	
R6/56	LKD		W24/56	9.40	0.34	8.02
R7/56	BEDROOM		W25/56	9.37	1.20	1.20
R8/56	LKD		W26/56	38.64	5.41	5.41
R9/56	BEDROOM		W27/56	8.69	1.16	1.16
R10/56	LD		W28/56	38.57	4.72	4.72
R11/56	BEDROOM		W29/56	8.68	1.16	1.16
R12/56	LKD		W30/56	38.43	5.53	5.53
R13/56	BEDROOM		W31/56	9.23	1.43	1.43
R14/56	LKD		W32/56	9.53	0.43	
R14/56	LKD		W33/56	38.14	4.40	
R14/56	LKD		W34/56	34.76	1.23	
R14/56	LKD		W35/56	34.77	1.04	
R14/56	LKD		W36/56	34.57	1.04	8.15
R15/56	BEDROOM		W37/56	34.39	3.44	3.44
R16/56	LKD		W38/56	34.18	1.64	1.64
R17/56	BEDROOM		W39/56	33.96	1.63	1.63
R18/56	LKD		W40/56	4.68	0.50	0.50
R19/56	BEDROOM		W41/56	7.61	0.60	0.60
R20/56	BEDROOM		W42/56	7.18	1.46	1.46
R1/57	LKD		W1/57	37.59	0.72	
R1/57	LKD		W2/57	38.41	1.24	1.97
R2/57	BEDROOM		W3/57	37.84	1.86	
R2/57	BEDROOM		W4/57	38.49	3.20	5.06
R3/57	BEDROOM		W5/57	38.91	1.75	
R3/57	BEDROOM		W6/57	39.09	3.30	5.05
R4/57	BEDROOM		W7/57	38.97	3.65	3.65
R5/57	BEDROOM		W8/57	39.36	6.35	6.35
R6/57	BEDROOM		W9/57	39.37	6.79	6.79
R7/57	LKD		W10/57	39.38	2.36	
R7/57	LKD		W11/57	39.36	0.89	
R7/57	LKD		W12/57	39.38	2.95	
R7/57	LKD		W13/57	39.35	3.02	9.22

Kensington Forum		INTERNAL DAYLIGHT ANALYSIS PROPOSED SCHEME 03/12/18				DEC 2018
Room	Roomuse	Flat	Window	VSC(%)	ADF(%)	TOTAL ADF(%)
R8/57	BEDROOM		W14/57	39.33	3.75	3.75
R9/57	BEDROOM		W15/57	39.31	3.77	3.77
R10/57	LKD		W16/57	39.30	3.01	3.01
R11/57	BEDROOM		W17/57	39.29	3.76	3.76
R12/57	LKD		W18/57	39.26	4.18	4.18
R13/57	BEDROOM		W19/57	39.23	4.07	4.07
R14/57	BEDROOM		W20/57	39.22	3.66	3.66
R15/57	LKD		W21/57	39.18	4.15	
R15/57	LKD		W22/57	36.08	1.56	
R15/57	LKD		W23/57	35.90	1.55	7.25
R16/57	BEDROOM		W24/57	35.74	3.55	3.55
R17/57	LKD		W25/57	35.55	1.69	1.69
R18/57	BEDROOM		W26/57	35.36	1.69	1.69
R19/57	LKD		W27/57	34.97	2.25	2.25
R20/57	BEDROOM		W28/57	34.69	2.27	2.27
R21/57	BEDROOM		W29/57	34.63	1.56	1.56
R1/58	BEDROOM		W1/58	35.78	0.91	
R1/58	BEDROOM		W2/58	37.49	1.68	2.59
R2/58	LKD		W3/58	36.09	0.54	
R2/58	LKD		W4/58	37.65	0.99	
R2/58	LKD		W5/58	38.10	0.58	
R2/58	LKD		W6/58	38.67	1.12	3.23
R3/58	BEDROOM		W7/58	38.23	3.50	3.50
R4/58	BEDROOM		W8/58	39.21	7.52	7.52
R5/58	BEDROOM		W9/58	39.22	6.00	6.00
R6/58	BEDROOM		W10/58	39.23	6.11	6.11
R7/58	LKD		W11/58	39.21	0.67	
R7/58	LKD		W12/58	39.12	2.18	
R7/58	LKD		W13/58	39.09	1.03	
R7/58	LKD		W14/58	39.10	1.02	
R7/58	LKD		W15/58	39.10	1.07	5.97
R8/58	BEDROOM		W16/58	39.10	3.32	3.32
R9/58	LKD		W17/58	39.10	2.85	2.85
R10/58	BEDROOM		W18/58	39.10	3.32	3.32
R11/58	LKD		W19/58	39.10	3.94	3.94

Room	Roomuse	Flat	Window	VSC(%)	ADF(%)	TOTAL ADF(%)
R12/58	BEDROOM		W20/58	39.10	3.03	3.03
R13/58	LKD		W21/58	39.10	1.15	
R13/58	LKD		W22/58	39.12	3.07	
R13/58	LKD		W23/58	37.10	1.26	
R13/58	LKD		W24/58	36.95	1.26	6.75
R14/58	BEDROOM		W25/58	36.82	3.69	3.69
R15/58	LKD		W26/58	36.67	1.76	1.76
R16/58	BEDROOM		W27/58	36.52	1.75	1.75
R17/58	LKD		W28/58	35.94	2.19	2.19
R18/58	BEDROOM		W29/58	35.72	2.23	2.23
R19/58	BEDROOM		W30/58	35.68	1.53	1.53



Room		Window	Room Use	Winter APSH	Window Annual APSH	Winter APSH	Room Annual APSH
Proposed Scheme							
R1/50	W1/50		BEDROOM	4	8	4	8
R2/50	W2/50		BEDROOM	4	8		
R2/50	W3/50		BEDROOM	3	7	4	8
R3/50	W4/50		LKD	4	9		
R3/50	W5/50		LKD	4	9	4	9
R4/50	W6/50		BEDROOM	3	8	3	8
R5/50	W7/50		BEDROOM	3	8	3	8
R6/50	W8/50		BEDROOM	3	8		
R6/50	W9/50		BEDROOM	7	9	9	16
R7/50	W10/50		BEDROOM	7	9	7	9
R8/50	W11/50		LKD	3	3		
R8/50	W12/50		LKD	7	9	8	10
R9/50	W13/50		BEDROOM	1	1	1	1
R10/50	W14/50		BEDROOM	6	8	6	8
R11/50	W15/50		BEDROOM	1	1	1	1
R12/50	W16/50		LKD	6	8		
R12/50	W17/50		LKD	3	3	7	9

**INTERNAL SUNLIGHT ANALYSIS
PROPOSED SCHEME 03/12/18**

DEC 2018

Room	Window	Room Use	Window		Room	
			Winter APSH	Annual APSH	Winter APSH	Annual APSH
R13/50	W18/50	LKD	2	2		
R13/50	W19/50	LKD	9	13		
R13/50	W20/50	LKD	0	19		
R13/50	W21/50	LKD	0	18	9	30
R14/50	W22/50	BEDROOM	0	16	0	16
R15/50	W23/50	BEDROOM	0	17	0	17
R16/50	W24/50	BEDROOM	0	15	0	15
R1/51	W1/51	BEDROOM	9	36		
R1/51	W2/51	BEDROOM	12	44		
R1/51	W3/51	BEDROOM	12	45		
R1/51	W4/51	BEDROOM	7	34	12	45
R2/51	W5/51	LKD	7	34		
R2/51	W6/51	LKD	12	45		
R2/51	W7/51	LKD	12	45		
R2/51	W8/51	LKD	11	44		
R2/51	W9/51	LKD	11	43	12	45
R3/51	W10/51	BEDROOM	8	36		
R3/51	W11/51	BEDROOM	5	30	9	37
R4/51	W12/51	BEDROOM	3	21		
R4/51	W13/51	BEDROOM	11	43		
R4/51	W14/51	BEDROOM	10	42	11	44
R5/51	W15/51	LKD	11	44		
R5/51	W16/51	LKD	9	42		

**INTERNAL SUNLIGHT ANALYSIS
PROPOSED SCHEME 03/12/18**

DEC 2018

Room	Window	Room Use	Window		Room	Window		Room
			Winter APSH	Annual APSH		Winter APSH	Annual APSH	
R5/51	W17/51	LKD	10	43				
R5/51	W18/51	LKD	9	42				
R5/51	W19/51	LKD	10	43				
R5/51	W20/51	LKD	9	41				
R5/51	W21/51	LKD	12	46				
R5/51	W22/51	LKD	13	67				
R5/51	W23/51	LKD	6	18		17	83	
R6/51	W24/51	BEDROOM	7	15		7	15	
R7/51	W25/51	LKD	18	72		18	72	
R8/51	W26/51	BEDROOM	8	18		8	18	
R9/51	W27/51	LD	14	68		14	68	
R10/51	W28/51	BEDROOM	6	18		6	18	
R11/51	W29/51	LKD	17	71		17	71	
R12/51	W30/51	BEDROOM	8	20		8	20	
R13/51	W31/51	LKD	7	16				
R13/51	W32/51	LKD	15	68				
R13/51	W33/51	LKD	1	26				
R13/51	W34/51	LKD	0	20				
R13/51	W35/51	LKD	1	21		16	70	
R14/51	W36/51	BEDROOM	1	21		1	21	
R15/51	W37/51	BEDROOM	1	21		1	21	

INTERNAL SUNLIGHT ANALYSIS
PROPOSED SCHEME 03/12/18

DEC 2018

Room	Window	Room Use	Window		Room	
			Winter APSH	Annual APSH	Winter APSH	Annual APSH
R16/51	W38/51	BEDROOM	1	18	1	18
R1/52	W1/52	BEDROOM	14	45	14	45
R2/52	W2/52	BEDROOM	13	44	13	44
R2/52	W3/52	BEDROOM	13	44		
R2/52	W4/52	BEDROOM	13	44		
R3/52	W5/52	LKD	13	45	13	47
R3/52	W6/52	LKD	13	45		
R3/52	W7/52	LKD	13	45		
R3/52	W8/52	LKD	13	47		
R3/52	W9/52	LKD	13	47		
R4/52	W10/52	BEDROOM	10	39	11	40
R4/52	W11/52	BEDROOM	7	32		
R5/52	W12/52	BEDROOM	4	22	15	50
R5/52	W13/52	BEDROOM	15	49		
R5/52	W14/52	BEDROOM	14	49		
R6/52	W15/52	LKD	15	50	26	95
R6/52	W16/52	LKD	14	49		
R6/52	W17/52	LKD	15	50		
R6/52	W18/52	LKD	14	48		
R6/52	W19/52	LKD	14	48		
R6/52	W20/52	LKD	12	46		
R6/52	W21/52	LKD	15	50		
R6/52	W22/52	LKD	19	73		
R6/52	W23/52	LKD	8	8		

INTERNAL SUNLIGHT ANALYSIS
PROPOSED SCHEME 03/12/18

DEC 2018

Room	Window	Room Use	Window Winter APSH	Window Annual APSH	Room Winter APSH	Room Annual APSH
R7/52	W24/52	BEDROOM	6	6	6	6
R8/52	W25/52	LKD	22	76	22	76
R9/52	W26/52	BEDROOM	6	6	6	6
R10/52	W27/52	LD	21	75	21	75
R11/52	W28/52	BEDROOM	6	6	6	6
R12/52	W29/52	LKD	20	74	20	74
R13/52	W30/52	BEDROOM	7	7	7	7
R14/52	W31/52	LKD	8	8		
R14/52	W32/52	LKD	21	75		
R14/52	W33/52	LKD	3	28		
R14/52	W34/52	LKD	1	22		
R14/52	W35/52	LKD	1	21	22	76
R15/52	W36/52	BEDROOM	1	21	1	21
R16/52	W37/52	BEDROOM	1	22	1	22
R17/52	W38/52	BEDROOM	1	21	1	21
R18/52	W39/52	LKD	0	1		
R18/52	W40/52	LKD	1	17	1	17
R19/52	W40/52	BEDROOM	1	17	1	17

INTERNAL SUNLIGHT ANALYSIS PROPOSED SCHEME 03/12/18

DEC 2018

Room	Window	Room Use	Window		Room	
			Winter APSH	Annual APSH	Winter APSH	Annual APSH
R20/52	W41/52	BEDROOM	3	25	3	25
R1/53	W1/53	BEDROOM	13	46		
R1/53	W2/53	BEDROOM	13	48		
R1/53	W3/53	BEDROOM	13	48		
R1/53	W4/53	BEDROOM	13	48	13	48
R2/53	W5/53	BEDROOM	13	48		
R2/53	W6/53	BEDROOM	13	48	13	48
R3/53	W7/53	LKD	13	48		
R3/53	W8/53	LKD	13	48	13	48
R4/53	W9/53	BEDROOM	11	41		
R4/53	W10/53	BEDROOM	7	33	11	41
R5/53	W11/53	BEDROOM	4	23		
R5/53	W12/53	BEDROOM	15	50		
R5/53	W13/53	BEDROOM	14	49	15	50
R6/53	W14/53	LKD	15	50		
R6/53	W15/53	LKD	14	49		
R6/53	W16/53	LKD	15	50		
R6/53	W17/53	LKD	14	49		
R6/53	W18/53	LKD	15	50		
R6/53	W19/53	LKD	14	49		
R6/53	W20/53	LKD	17	53		
R6/53	W21/53	LKD	27	82		
R6/53	W22/53	LKD	11	18	28	97

**INTERNAL SUNLIGHT ANALYSIS
PROPOSED SCHEME 03/12/18**

DEC 2018

Room	Window	Room Use	Window		Room	
			Winter APSH	Annual APSH	Winter APSH	Annual APSH
R7/53	W23/53	BEDROOM	13	16	13	16
R8/53	W24/53	LKD	27	82	27	82
R9/53	W25/53	BEDROOM	13	18	13	18
R10/53	W26/53	LD	25	80	25	80
R11/53	W27/53	BEDROOM	11	18	11	18
R12/53	W28/53	LKD	25	80	25	80
R13/53	W29/53	BEDROOM	11	18	11	18
R14/53	W30/53	LKD	14	18		
R14/53	W31/53	LKD	26	81		
R14/53	W32/53	LKD	4	31		
R14/53	W33/53	LKD	2	24		
R14/53	W34/53	LKD	2	24	26	81
R15/53	W35/53	BEDROOM	2	24	2	24
R16/53	W36/53	BEDROOM	2	24	2	24
R17/53	W37/53	BEDROOM	2	23	2	23
R18/53	W38/53	LKD	0	2		
R18/53	W39/53	LKD	1	18	1	18
R19/53	W39/53	BEDROOM	1	18	1	18

INTERNAL SUNLIGHT ANALYSIS
PROPOSED SCHEME 03/12/18

DEC 2018

Room	Window	Room Use	Window		Room	Window		Room
			Winter APSH	Annual APSH		Winter APSH	Annual APSH	
R20/53	W40/53	BEDROOM	3	26		3	26	
R1/54	W1/54	BEDROOM	15	47				
R1/54	W2/54	BEDROOM	15	48				
R1/54	W3/54	BEDROOM	15	48				
R1/54	W4/54	BEDROOM	15	48		15	48	
R2/54	W5/54	BEDROOM	15	48				
R2/54	W6/54	BEDROOM	15	48		15	48	
R3/54	W7/54	LKD	15	47				
R3/54	W8/54	LKD	15	48		15	48	
R4/54	W9/54	BEDROOM	12	42				
R4/54	W10/54	BEDROOM	7	33		12	42	
R5/54	W11/54	BEDROOM	4	23				
R5/54	W12/54	BEDROOM	16	51				
R5/54	W13/54	BEDROOM	15	50		16	51	
R6/54	W14/54	LKD	16	51				
R6/54	W15/54	LKD	15	50				
R6/54	W16/54	LKD	16	51				
R6/54	W17/54	LKD	15	50				
R6/54	W18/54	LKD	16	51				
R6/54	W19/54	LKD	15	50				
R6/54	W20/54	LKD	18	53				
R6/54	W21/54	LKD	27	81				
R6/54	W22/54	LKD	9	9		29	98	
R7/54	W23/54	BEDROOM	9	9		9	9	

INTERNAL SUNLIGHT ANALYSIS
PROPOSED SCHEME 03/12/18

DEC 2018

Room	Window	Room Use	Window APSH	Winter APSH	Window Annual APSH	Winter APSH	Room Annual APSH
R8/54	W24/54	LKD	27	27	81	27	81
R9/54	W25/54	BEDROOM	8	8	8	8	8
R10/54	W26/54	LD	27	27	81	27	81
R11/54	W27/54	BEDROOM	9	9	9	9	9
R12/54	W28/54	LKD	27	27	81	27	81
R13/54	W29/54	BEDROOM	9	9	9	9	9
R14/54	W30/54	LKD	10	10	10		
R14/54	W31/54	LKD	26	26	80		
R14/54	W32/54	LKD	4	4	30		
R14/54	W33/54	LKD	2	2	24		
R14/54	W34/54	LKD	2	2	24	26	80
R15/54	W35/54	BEDROOM	2	2	24	2	24
R16/54	W36/54	LKD	2	2	24		
R16/54	W37/54	LKD	2	2	23	2	24
R17/54	W37/54	BEDROOM	2	2	23	2	23
R18/54	W38/54	LKD	0	0	4		
R18/54	W39/54	LKD	1	1	19	1	20
R19/54	W39/54	BEDROOM	1	1	19	1	19

INTERNAL SUNLIGHT ANALYSIS
PROPOSED SCHEME 03/12/18

DEC 2018

Room	Window	Room Use	Window		Room	
			Winter APSH	Annual APSH	Winter APSH	Annual APSH
R20/54	W40/54	BEDROOM	3	25	3	25
R1/55	W1/55	BEDROOM	12	42	12	42
R1/55	W2/55	BEDROOM	12	42		
R2/55	W3/55	BEDROOM	15	50	15	50
R2/55	W4/55	BEDROOM	15	50		
R3/55	W5/55	LKD	15	50	15	50
R3/55	W6/55	LKD	15	50		
R3/55	W7/55	LKD	15	50		
R3/55	W8/55	LKD	15	50		
R3/55	W9/55	LKD	15	50		
R3/55	W10/55	LKD	15	50		
R4/55	W11/55	BEDROOM	12	42	12	42
R4/55	W12/55	BEDROOM	7	33		
R5/55	W13/55	BEDROOM	4	23	16	51
R5/55	W14/55	BEDROOM	16	51		
R5/55	W15/55	BEDROOM	15	50		
R6/55	W16/55	LKD	16	51	30	99
R6/55	W17/55	LKD	15	50		
R6/55	W18/55	LKD	16	51		
R6/55	W19/55	LKD	15	50		
R6/55	W20/55	LKD	16	51		
R6/55	W21/55	LKD	15	50		
R6/55	W22/55	LKD	18	54		
R6/55	W23/55	LKD	28	83		
R6/55	W24/55	LKD	12	19		

INTERNAL SUNLIGHT ANALYSIS
PROPOSED SCHEME 03/12/18

DEC 2018

Room	Window	Room Use	Window		Room	
			Winter APSH	Annual APSH	Winter APSH	Annual APSH
R7/55	W25/55	BEDROOM	13	16	13	16
R8/55	W26/55	LKD	28	83	28	83
R9/55	W27/55	BEDROOM	13	18	13	18
R10/55	W28/55	LD	28	83	28	83
R11/55	W29/55	BEDROOM	11	18	11	18
R12/55	W30/55	LKD	28	83	28	83
R13/55	W31/55	BEDROOM	11	18	11	18
R14/55	W32/55	LKD	14	18		
R14/55	W33/55	LKD	27	82		
R14/55	W34/55	LKD	5	32		
R14/55	W35/55	LKD	3	25		
R14/55	W36/55	LKD	3	25	27	82
R15/55	W37/55	BEDROOM	3	25	3	25
R16/55	W38/55	LKD	3	25		
R16/55	W39/55	LKD	3	25	3	25
R17/55	W39/55	BEDROOM	3	25	3	25
R18/55	W40/55	LKD	0	4		
R18/55	W41/55	LKD	2	19	2	19

Room	Window	Room Use	Window		Room	
			Winter APSH	Annual APSH	Winter APSH	Annual APSH
R19/55	W41/55	BEDROOM	2	19	2	19
R20/55	W42/55	BEDROOM	4	20	4	20
R1/56	W1/56	BEDROOM	12	42	12	42
R1/56	W2/56	BEDROOM	12	42		
R2/56	W3/56	BEDROOM	15	48	15	48
R2/56	W4/56	BEDROOM	15	48		
R3/56	W5/56	LKD	15	48	15	48
R3/56	W6/56	LKD	15	48		
R3/56	W7/56	LKD	15	48		
R3/56	W8/56	LKD	15	48		
R3/56	W9/56	LKD	15	48		
R3/56	W10/56	LKD	15	48		
R4/56	W11/56	BEDROOM	12	42		
R4/56	W12/56	BEDROOM	7	33	12	42
R5/56	W13/56	BEDROOM	5	24	16	49
R5/56	W14/56	BEDROOM	16	49		
R5/56	W15/56	BEDROOM	15	48		
R6/56	W16/56	LKD	16	49	18	52
R6/56	W17/56	LKD	15	48		
R6/56	W18/56	LKD	16	49		
R6/56	W19/56	LKD	15	48		
R6/56	W20/56	LKD	16	49		
R6/56	W21/56	LKD	15	48		
R6/56	W22/56	LKD	18	52		

INTERNAL SUNLIGHT ANALYSIS
PROPOSED SCHEME 03/12/18

DEC 2018

Room	Window	Room Use	Window		Room	
			Winter APSH	Annual APSH	Winter APSH	Annual APSH
R6/56	W23/56	LKD	28	82		
R6/56	W24/56	LKD	10	10	30	99
R7/56	W25/56	BEDROOM	9	9	9	9
R8/56	W26/56	LKD	28	82	28	82
R9/56	W27/56	BEDROOM	8	8	8	8
R10/56	W28/56	LD	28	82	28	82
R11/56	W29/56	BEDROOM	9	9	9	9
R12/56	W30/56	LKD	28	82	28	82
R13/56	W31/56	BEDROOM	9	9	9	9
R14/56	W32/56	LKD	10	10		
R14/56	W33/56	LKD	28	82		
R14/56	W34/56	LKD	5	31		
R14/56	W35/56	LKD	3	25		
R14/56	W36/56	LKD	4	26	28	82
R15/56	W37/56	BEDROOM	4	26	4	26
R16/56	W38/56	LKD	4	26		
R16/56	W39/56	LKD	4	26	4	26
R17/56	W39/56	BEDROOM	4	26	4	26
R18/56	W40/56	LKD	0	4		

**INTERNAL SUNLIGHT ANALYSIS
PROPOSED SCHEME 03/12/18**

DEC 2018

Room	Window	Room Use	Window		Room	
			Winter APSH	Annual APSH	Winter APSH	Annual APSH
R18/56	W41/56	LKD	3	9	3	9
R19/56	W41/56	BEDROOM	3	9	3	9
R20/56	W42/56	BEDROOM	3	9	3	9
R1/57	W1/57	LKD	10	40		
R1/57	W2/57	LKD	9	36	10	40
R2/57	W3/57	BEDROOM	10	40		
R2/57	W4/57	BEDROOM	9	36	10	40
R3/57	W5/57	BEDROOM	11	41		
R3/57	W6/57	BEDROOM	10	40	11	41
R4/57	W7/57	BEDROOM	12	43	12	43
R5/57	W8/57	BEDROOM	16	51	16	51
R6/57	W9/57	BEDROOM	16	51	16	51
R7/57	W10/57	LKD	16	51		
R7/57	W11/57	LKD	12	42		
R7/57	W12/57	LKD	28	79		
R7/57	W13/57	LKD	28	79	30	97
R8/57	W14/57	BEDROOM	26	70	26	70
R9/57	W15/57	BEDROOM	26	71	26	71
R10/57	W16/57	LKD	28	74	28	74

INTERNAL SUNLIGHT ANALYSIS
PROPOSED SCHEME 03/12/18

DEC 2018

Room	Window	Room Use	Window APSH	Winter APSH	Window Annual APSH	Winter APSH	Room Annual APSH
R11/57	W17/57	BEDROOM	26	26	71	26	71
R12/57	W18/57	LKD	28	28	79	28	79
R13/57	W19/57	BEDROOM	26	26	70	26	70
R14/57	W20/57	BEDROOM	25	25	68	25	68
R15/57	W21/57	LKD	28	28	80	28	80
R15/57	W22/57	LKD	4	4	26	4	26
R15/57	W23/57	LKD	4	4	26	4	26
R16/57	W24/57	BEDROOM	4	4	26	4	26
R17/57	W25/57	LKD	4	4	26	4	26
R17/57	W26/57	LKD	4	4	26	4	26
R18/57	W26/57	BEDROOM	4	4	26	4	26
R19/57	W27/57	LKD	6	6	32	6	32
R20/57	W28/57	BEDROOM	4	4	26	4	26
R21/57	W29/57	BEDROOM	3	3	23	3	23
R1/58	W1/58	BEDROOM	10	10	39	10	39
R1/58	W2/58	BEDROOM	9	9	36	9	36
R2/58	W3/58	LKD	10	10	39	10	39
R2/58	W4/58	LKD	9	9	36	9	36

**INTERNAL SUNLIGHT ANALYSIS
PROPOSED SCHEME 03/12/18**

DEC 2018

Room	Window	Room Use	Window		Room	
			Winter APSH	Annual APSH	Winter APSH	Annual APSH
R2/58	W5/58	LKD	11	41		
R2/58	W6/58	LKD	10	40	11	41
R3/58	W7/58	BEDROOM	12	43	12	43
R4/58	W8/58	BEDROOM	16	51	16	51
R5/58	W9/58	BEDROOM	16	51	16	51
R6/58	W10/58	BEDROOM	16	51	16	51
R7/58	W11/58	LKD	12	42		
R7/58	W12/58	LKD	28	78		
R7/58	W13/58	LKD	26	69		
R7/58	W14/58	LKD	26	70		
R7/58	W15/58	LKD	26	70	30	97
R8/58	W16/58	BEDROOM	26	71	26	71
R9/58	W17/58	LKD	28	74	28	74
R10/58	W18/58	BEDROOM	26	71	26	71
R11/58	W19/58	LKD	28	77	28	77
R12/58	W20/58	BEDROOM	26	70	26	70
R13/58	W21/58	LKD	25	68		
R13/58	W22/58	LKD	28	77		
R13/58	W23/58	LKD	4	26		
R13/58	W24/58	LKD	4	26	28	79

Room	Window	Room Use	Window		Room	
			Winter APSH	Annual APSH	Winter APSH	Annual APSH
R14/58	W25/58	BEDROOM	4	26	4	26
R15/58	W26/58	LKD	4	26		
R15/58	W27/58	LKD	4	26	4	26
R16/58	W27/58	BEDROOM	4	26	4	26
R17/58	W28/58	LKD	6	32	6	32
R18/58	W29/58	BEDROOM	4	26	4	26
R19/58	W30/58	BEDROOM	3	23	3	23